

PD662 General Purpose NEMA 4X, IP66 Loop-Powered Meter Instruction Manual



Survivor



Process Meter

- NEMA 4X, IP66 Loop-Powered Field-Mount Process Meter
- 4-20 mA Input
- 0.6" (15.2 mm) 3½+ Digits LCD Display; -1999 to 2999
- 1.7 Volt Drop (3.7 Volt Drop with Backlight)
- HART® Protocol Transparent
- Loop-Powered Backlight Option
- CSA Certified for -40 to 75°C (-40 to 167°F) Operation
- Four Internal Buttons for Easy Field Scaling
- Max/Min Display
- Programmable noise filter
- 32-Point and Square Root Linearization Functions
- Plastic NEMA 4X, IP66 Enclosure
- Conformal Coated PCBs for Dust and Humidity Protection
- One ½" Conduit Hole in Rear of Enclosure
- Pipe & Panel Mounting Kits
- Stainless Steel Tag Available

PRECISION DIGITAL CORPORATION



Disclaimer

The information contained in this document is subject to change without notice. Precision Digital makes no representations or warranties with respect to the contents hereof; and specifically disclaims any implied warranties of merchantability or fitness for a particular purpose.



CAUTION: *Read complete instructions prior to installation and operation of the meter.*



WARNING: *Risk of electric shock or personal injury*



Warnings

- This product is not recommended for life support applications or applications where malfunctioning could result in personal injury or property loss. Anyone using this product for such applications does so at his/her own risk. Precision Digital Corporation shall not be held liable for damages resulting from such improper use.
- Cancer and Reproductive Harm
www.P65Warnings.ca.gov. For California Proposition 65 details please visit our website www.predig.com

Limited Warranty

Precision Digital Corporation warrants this product against defects in material or workmanship for the specified period under "Specifications" from the date of shipment from the factory. Precision Digital's liability under this limited warranty shall not exceed the purchase value, repair, or replacement of the defective unit.

Registered Trademarks

All trademarks mentioned in this document are the property of their respective owners.

© 2018 Precision Digital Corporation. All rights reserved.

www.predig.com

Introduction

The PD662 NEMA 4X, CSA Certified loop-powered meter is perfect for applications where a simple, inexpensive display is required and AC power is not available. The PD662 derives all its power from the 4-20 mA loop, including its optional backlight feature. It can be easily scaled in the field using four push buttons; with or without applying an actual calibration signal. The PD662's display will read up to 2999; we call this 3½+ digits! The PD662 is housed in a rugged NEMA 4X enclosure and is provided with one ½" NPT pipe conduit hole.

Ordering information

Model	Options Installed
PD662-0L0-00*	None
PD662-0K0-00	Loop-Powered Backlight

* Quick Shipment Program product typically shipped within 2 working days

Accessories

Model	Description
PDA1024-01	24 VDC Power Supply for DIN Rail
PDA6624	Panel Mounting Kit
PDA6845	2" Pipe Mounting Kit
PDA-SSTAG	Stainless Steel Tag

Table of Contents

INTRODUCTION	2
ORDERING INFORMATION	2
SPECIFICATIONS	4
General	4
Input	4
COMPLIANCE INFORMATION	4
Safety	4
Electromagnetic Compatibility	5
SAFETY INFORMATION	5
INSTALLATION	5
Unpacking	5
Mounting	5
PD662 Connections	6
Connection & Wiring Diagrams	6
SETUP AND PROGRAMMING	6
Front Panel Buttons	6
Setting Numeric Values	7
Programming the Meter	7
Main Menu	7
Main Menu Display Functions & Messages	8
Setting the Decimal Point (dP)	8
Scaling the Meter (SL)	8
Calibrating the Meter (RL)	9
Recalibrating the Internal Calibration Reference (iRL)	9
Advanced Features Menu	9
Advanced Features Menu & Display Messages	9
Signal Input Conditioning Function (FnC)	10
Information Menu ($InfO$)	10
Input Signal Filter (FIL)	10
Internal Calibration (iRL)	11
OPERATION	11
Front Panel Buttons Operation	11
Maximum & Minimum Readings (Hl & Ll)	12
Reset Meter to Factory Defaults	12
Factory Defaults & User Settings	13
MOUNTING DIMENSIONS	13
TROUBLESHOOTING	14
Troubleshooting Tips	14
QUICK USER INTERFACE	
REFERENCE GUIDE	15
EU DECLARATION OF CONFORMITY	17

Table of Figures

Figure 1. PD662 Mounting Board Rear View	6
Figure 2. PD662 Input Connections without Backlight	6
Figure 3. PD662 Input Connections with Backlight	6
Figure 4. Case Dimensions – Front View	13
Figure 5. Case Dimensions – Side View	13
Figure 6. Case Dimensions – Bottom View	13
Figure 7. PDA6845 Pipe Mounting Kit	14

Specifications

Except where noted all specifications apply to operation at +25

General

DISPLAY	0.6" (15.2 mm) LCD, 3½+ digits; -1999 to 2999
DISPLAY UPDATE RATE	2 Updates/Second
OVERRANGE	Display flashes 2999
UNDERRANGE	Display flashes -1999
PROGRAMMING METHOD	Four internal pushbuttons
NOISE FILTER	Programmable H I , LQ , or OFF
RECALIBRATION	Recalibration is recommended at least every 12 months.
MAX/MIN DISPLAY	Max/Min readings reached by the process are stored until reset by the user or until power to the meter is turned off.
NON-VOLATILE MEMORY	All programmed settings are stored in non-volatile memory for a minimum of ten years if power is lost.
NORMAL MODE REJECTION	64 dB at 50/60 Hz
ENVIRONMENTAL	Operating temperature for CSA certification: -40 to 75°C Functional temperature range: -40 to 85°C Storage temperature range: -40 to 85°C Relative humidity: 0 to 90% non-condensing
CONNECTIONS	Removable screw terminals accept 12 to 22 AWG wire
ENCLOSURE	Impact resistant polyester plastic, body gray, cover clear with blue faceplate; NEMA 4X, IP66; ½" conduit hole provided at base.
MOUNTING	½" NPT pipe (0.865 in, 12.7 mm) conduit hole on bottom of enclosure. 0.166 in (4.2 mm) wall mounting holes located behind front cover screws.
TIGHTENING TORQUE	Screw terminal connectors: 4.5 lb-in (0.5 Nm)
OVERALL DIMENSIONS	4.33" x 3.15" x 2.76" (110 mm x 80 mm x 70 mm)
WEIGHT	10.4 oz (295 g)
WARRANTY	3 years parts and labor

Input

ACCURACY	±1 count	
FUNCTION	Linear (2 to 32 points) or square root	
TEMPERATURE DRIFT	50 PPM/°C from -40 to 85°C ambient	
DECIMAL POINT	User selectable decimal point	
MINIMUM SPAN	Input 1 & Input 2: 0.40 mA	
CALIBRATION RANGE	An <i>Error</i> message will appear if input 1 and input 2 signals are too close together.	
	Input Range	Minimum Span Input 1 & Input 2
	4-20 mA	0.40 mA
MAXIMUM VOLTAGE DROP	Without Backlight	With Backlight
	1.7 VDC @ 20 mA	3.7 VDC @ 20 mA
EQUIVALENT RESISTANCE	85 Ω @ 20 mA	185 Ω @ 20 mA
INPUT OVERLOAD	Over current protection to 2 A max.	

Compliance Information

Safety

CSA Certified	U.S. & Canada 2252 05 – Process Control Equipment 2252 85 – Process Control Equipment, U.S. Standards
CSA File Number	157123
CSA Applicable Requirements	CAN/CSA C22.2 No. 61010-1-04 Safety Requirements for Electrical Equipment for Measurement, Control, and Laboratory Use – Part 1: General Requirements UL 61010-1:2004, 2 nd Edition Safety Requirements for Electrical Equipment for Measurement, Control, and Laboratory Use – Part 1: General Requirements
Low Voltage Directive	EN 61010-1:2010 Safety requirements for measurement, control, and laboratory use IEC 61010-1:2010 Safety requirements for measurement, control, and laboratory use

Electromagnetic Compatibility

EMC	EN 61326-1:2013
Emissions & Immunity	EMC requirements for Electrical equipment for measurement, control and laboratory use – Industrial

Safety Information



CAUTION:

Read complete instructions prior to installation and operation of the meter.

The equipment shall be installed by qualified personnel in accordance with applicable local and national regulations (e.g. CEC, NEC, FCC, SCC, etc).

Follow all safety and operation guidelines in this manual. If the meter is used in a manner not recommended by the manufacturer, the overall safety will be impaired.

Installation and service should be performed only by trained service personnel.

This unit is not suitable for hazardous locations such as potentially explosive zones or locations.

No user replaceable part inside. All service shall be performed at the factory.

Do not disconnect and reconnect cables during a lightning storm.

Suitable surge suppressor (e.g. lightning protection) shall be provided in end application installation.

Installation

All pushbuttons and wiring connectors are accessed by opening the NEMA 4X enclosure by removing the 4 captive screws that secure the cover.

Unpacking

Remove the meter from box. Inspect the packaging and contents for damage. Report damages, if any, to the carrier.

If any part is missing or the meter malfunctions, please contact your supplier or the factory for assistance.

Mounting

The PD662 can be wall mounted using the mounting holes beneath the cover screws. A ½" NPT pipe conduit hole is provided. It can be panel mounted with the addition of the PDA6624 panel mount kit. It can also be pipe mounted by using the PDA6845 pipe mount kit.

Refer to Mounting Dimensions, page 13 for details on wall or panel space requirements.



The unit shall be installed in a way that will prevent any accidental contact of the internal meter circuits and power supply lines.



Cable suitable for outdoor use and a CSA Approved gland rated 4X, or a suitable conduit and a CSA Approved connector rated 4X, is intended to be used in final installation.



Metallic conduit shall be reliably bonded to protective earth/ground without creating any ground loop.

Connections

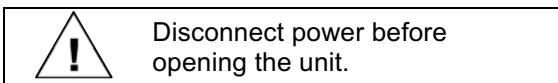

Disconnect power before opening the unit.

To access the connectors, remove the enclosure cover and unscrew the two captive stainless-steel screws on the rear mounting board. Remove the meter assembly from the enclosure. Signal connections are made to a three-terminal removable connector. The signal wiring terminal block is on the rear of the meter assembly.

- S+** 4-20 mA signal input positive terminal connection
- S-** 4-20 mA signal return/negative terminal connection
- X** Not connected (no backlight option)
- B-** 4-20 mA signal return/negative terminal when using the installed loop powered backlight option

Refer to **Figure 1** for terminal positions on the rear of the mounting board inside the meter enclosure.

- P+** 24 VDC power positive terminal connection
- P-** 24 VDC power negative terminal connection

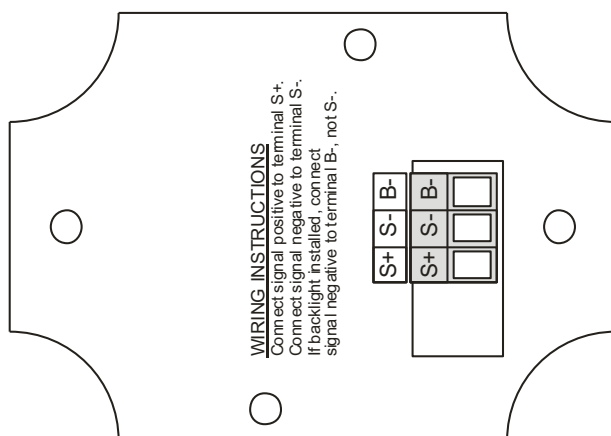

Figure 1. PD662 Mounting Board Rear View

Connection & Wiring Diagrams

Signal input connections are made to a three-terminal connector labeled S+|S-|X for models without a backlight and S+|S-|B- for models with a backlight. The 4-20 mA input with no backlight has a maximum voltage drop of 1.7 V and is wired as shown in

Figure 2. The loop-powered backlight configuration requires a total maximum voltage drop of 3.7 V. The backlight is recommended for dim lighting conditions and is enabled when wired as shown in **Figure 3**.

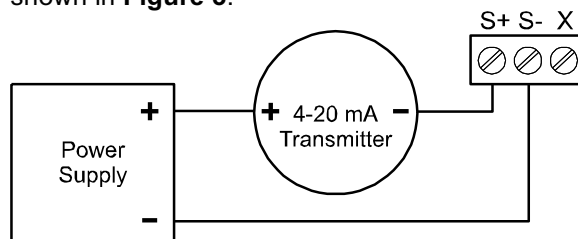

Figure 2. PD662 Input Connections without Backlight

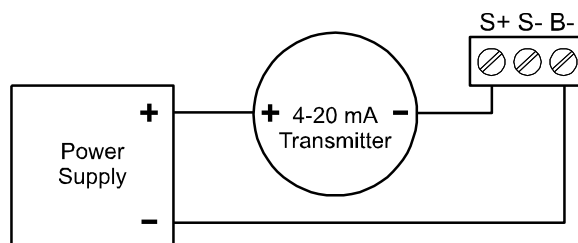

Figure 3. PD662 Input Connections with Backlight

Setup and Programming

- There is **no need to recalibrate** the meter for milliamps when first received from the factory.
- The meter is **factory calibrated** for milliamps prior to shipment. The calibration equipment is certified to NIST standards.

Overview

There are no jumpers involved in the setup process of the meter. Setup and programming is done through the front panel buttons. After all connections have been completed and verified, apply power to the loop.

For a Quick User Interface Reference Guide go to page 15

Front Panel Buttons

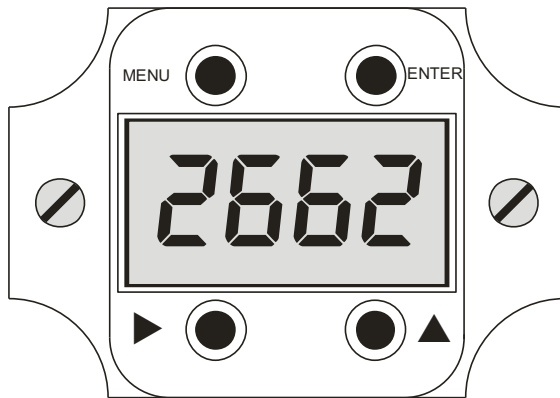

Button/ Symbol	Description
MENU	Menu button to enter programming mode. Press and hold for 5 seconds to access the <i>Advanced</i> features of the meter.
ENTER	Enter button to access a menu or accept a setting.
▶	Right arrow to scroll through the menus or move to the next digit or decimal position during programming. Displays the Max then Min display values when pressed during normal run mode.
▲	Up arrow to scroll through the menus, decimal point, or to increment the value of a digit. Resets the Max and Min display value when pressed during normal run mode.

Setting Numeric Values

The numeric values are set using the **Right** and **Up** arrow buttons. Press **Right** arrow to select next digit and **Up** arrow to increment digit. The two left-most digits on the display are set as a single digit, able to display -19 to 29.

The digit being changed blinks.

Press the **Enter** button, at any time, to accept a setting or **Menu** button to exit without saving changes.

The decimal point is set using the **Right** or **Up** arrow button in the *Setup-decimal point* menu.

Programming the Meter

It is **very important** to read the following information, before proceeding to program the meter:

- There is **no need to recalibrate** the meter for milliamps when first received from the factory.
- The meter is **factory calibrated** for milliamps prior to shipment. The calibration equipment is certified to NIST standards.
- Use the *Scale (SCL)* menu to enter scale parameters without applying a live signal.
- Alternatively, use the *Calibrate (CAL)* menu to apply a signal from a calibrator or a 4-20 mA transmitter to calibrate the meter.

Inputs may be calibrated or scaled to any display within the range of the meter.

Additional parameters, not needed for most applications, are viewed and programmed with the *Advanced Features* menu, see *Advanced Features Menu* on page 9.

Main Menu

The main menu consists of the most commonly used functions: *Decimal Point Location*, *Scale*, and *Calibration*.

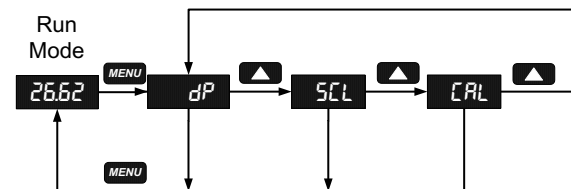

- Press **Menu** button to enter Programming Mode then press the **Up** arrow button to scroll main menu.
- Press **Menu**, at any time, to exit and return to Run Mode. Changes made to settings prior to pressing **Enter** are not saved.
- Changes to the settings are saved to memory only after pressing **Enter**.
- The display moves to the next menu every time a setting is accepted by pressing **Enter**.

Main Menu Display Functions & Messages

The meter displays various functions and messages during setup, programming, and operation. The following table shows the main menu functions and messages in the order they appear in the menu.

Display	Parameter	Action/Setting
dP	<i>Decimal point</i>	Set decimal point
$5CL$	<i>Scale</i>	Enter the <i>Scale</i> menu
nPt	<i>Number of Points</i>	Set number of linearization points
$in1$	<i>Scale Input 1</i>	Input signal 1 value (mA)
$d1$	<i>Scale Display 1</i>	Scaled value for input 1
$in2$	<i>Scale Input 2</i>	Input signal 2 value (mA)
$d2$	<i>Scale Display 2</i>	Scaled value for input 2
CRl	<i>Calibrate</i>	Enter the <i>Calibrate</i> menu
nPt	<i>Number of Points</i>	Set number of linearization points
$in1$	<i>Calibrate Input 1</i>	Read input signal 1
$d1$	<i>Calibrate Display 1</i>	Enter value for input 1
$in2$	<i>Calibrate Input 2</i>	Read input signal 2
$d2$	<i>Calibrate Display 2</i>	Enter value for input 2

Setting the Decimal Point (dP)

Decimal point may be set with up to three decimal places or with no decimal point at all. Pressing the **Right** or **Up** arrow moves the decimal point one place to the right until no decimal point is displayed, then it moves to the left most position.

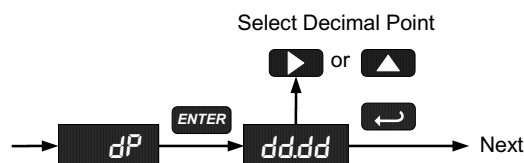

Scaling the Meter ($5CL$)

The 4-20 mA input can be scaled to display the process in engineering units.

A signal source is not needed to scale the meter; simply program the inputs and corresponding display values.

If using linear signal input conditioning, enter the number of scale points (2-32), followed by the input values and display values. If using square root signal input conditioning, the number of points input menu will not be present.

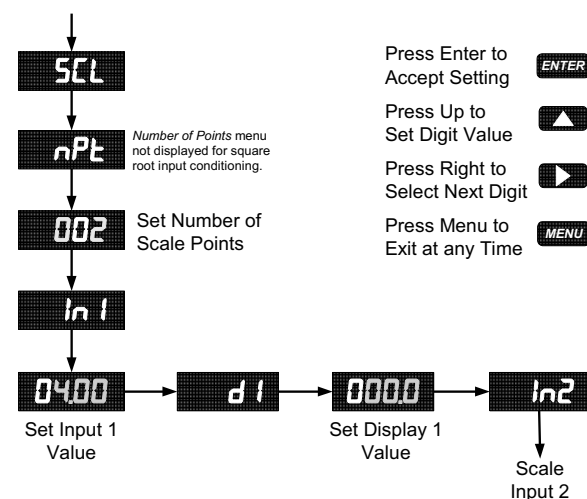

Number of Points (nPt)

Set the number of linearization points used in the *Scale* menu. 2 to 32 points may be used. The *Scale* menu is entered after entering the number of points

Minimum Input Span

The minimum input span is the minimum difference between input 1 and input 2 signals required to complete the calibration or scaling of the meter. The minimum span is 0.40 mA.

If the minimum span is not maintained, the meter reverts to input 2, allowing the appropriate input signals to be applied.

Calibrating the Meter (CAL)

To scale the meter without a signal source, refer to Scaling the Meter (SCAL), page 8.

The meter can be calibrated to display the process in engineering units by applying the appropriate input signal. The use of a calibrated signal source is strongly recommended.

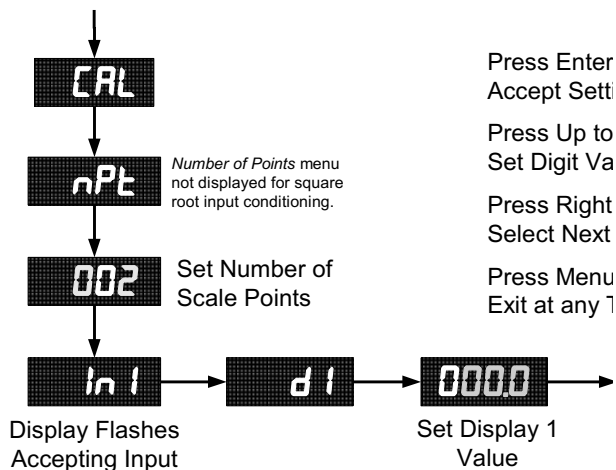

1. Press the **Up** arrow button to scroll to the *Calibration* menu (**CAL**) and press **Enter**.
2. If using linear signal input conditioning, enter the number of calibration points (2-32).
3. The meter displays **In 1**. Apply a known signal and press **Enter**. The display will flash while accepting the signal.
4. When the meter displays **d 1**, press **Enter**. Enter a corresponding display value for the signal input, and press **Enter** to accept.
5. The meter displays **n2**. Apply a known signal and press **Enter**. The display will flash while accepting the signal.
6. When the meter displays **d2**, press **Enter**. Enter a corresponding display value for the signal input, and press **Enter** to accept.

Recalibrating the Internal Calibration Reference (ICAL)

The *Internal Calibration* (**ICAL**) menu, located in the *Advanced Features* menu, is used to recalibrate the internal calibration reference. Recalibration is recommended at least every twelve months. Refer to Internal Calibration (**ICAL**), page 11 for instructions.

Advanced Features Menu

To simplify the setup process, functions not needed for most applications are located in the *Advanced Features* menu. Press and hold the **MENU** button for five seconds to access the *Advanced Features* menu

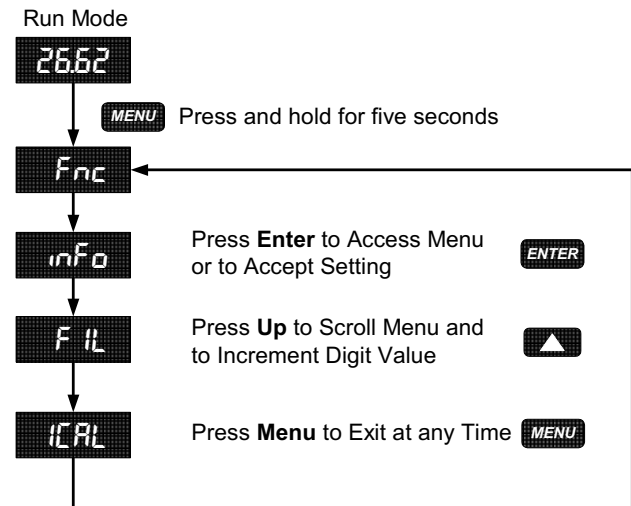

Advanced Features Menu & Display Messages

The following table shows the *Advanced* features menu functions and messages in the order they appear in the menu.

Display	Parameter	Action/Setting
$F_{n\bar{L}}$	<i>Input Function</i>	Set linear or square root input conditioning function
L_{nr}	<i>Linear</i>	Set linear scaling
S_{qr}	<i>Square Root</i>	Set square root input conditioning function
$Inf\alpha$	<i>Information</i>	Enter the <i>Information</i> menu
S_{Ft}	<i>Software Information</i>	Software release number
U_{Er}	<i>Version</i>	Meter firmware version
$^{\circ}C$	<i>Calibration Temp (°C)</i>	Temperature at time of I-calibration (°C)
$^{\circ}F$	<i>Calibration Temp (°F)</i>	Temperature at time of I-calibration (°F)
F_{IL}	<i>Filter</i>	Set filter function level
I_{CAL}	<i>I-Calibration</i>	Internal master factory calibration
r_{St}	<i>Reset Defaults</i>	Restore factory default parameter settings

Signal Input Conditioning Function ($F_{n\bar{L}}$)

The PD662 provides linear and square root signal input conditioning functions for inputs from linear and non-linear transmitters.

Linear (L_{nr})

Meters are set up at the factory for linear function using two-point linearization. Multi-point linearization with up to 32 points may be used. The linear function provides a display that is linear with respect to the input signal between each set of input points.

Square Root (S_{qr})

The square root function is used to linearize the signal from a differential pressure transmitter and display flow rate in engineering units.

Information Menu ($Inf\alpha$)

The Information menu is located in the *Advanced Features* menu, to access Information menu see Advanced Features Menu on page 9.

It shows software identification number, version number, and calibration temperatures. To determine the software version of a meter:

1. Go to the *Information* menu ($Inf\alpha$) and press **Enter** button.
2. The meter will automatically scroll through the software release number and software version. The meter temperatures at the time of last internal calibration in °C and °F are displayed for calibration troubleshooting. Pressing the **ENTER**, **RIGHT**, or **UP** buttons will progress the information display.
3. Following the information display, the meter will exit the *Advanced Features* menu and return to run mode.

Input Signal Filter (F_{IL})

The noise filter is available for unusually noisy signals that cause an unstable process variable display. The noise filter averages the input signal over a certain period. The filter level can be set to low ($L\bar{D}$), high ($H\bar{I}$), or off ($\bar{O}FF$). The higher the filter setting, the longer the averaging time and so the longer the display may take to find its final value.

The filter contains a noise filter bypass feature so that while small variations in the signal will be filtered out, large, abrupt changes to the input signal are displayed immediately.

Internal Calibration ($\overline{I\overline{C}RL}$)

- There is **no need to recalibrate** the meter for milliamps when first received from the factory.
- The meter is **factory calibrated** for milliamps prior to shipment. The calibration equipment is certified to NIST standards.

The internal calibration allows the user to scale the meter without applying a signal. The use of a calibrated signal source is necessary to perform the internal calibration of the meter. Check calibration of the meter at least every 12 months.

Notes:

- The signal source must have a full-scale accuracy of 0.01% or better between 4 and 20 mA in order to maintain the specified accuracy of the meter.
- Allow the meter to warm up for at least 15 minutes before performing the internal calibration procedure.

The *Internal calibration* menu is part of the *Advanced Features* menu.

1. Press and hold the **MENU** button for 5 seconds to enter the *Advanced Features* menu.
2. Press the **Up** arrow button to scroll to the *Internal Calibration* menu ($\overline{I\overline{C}RL}$) and press **Enter**.
3. The meter displays 4.00 mA. Apply a 4.00 mA signal and press **Enter**. The display flashes for a moment while the meter is accepting the signal.
4. After the signal is accepted, the meter displays 20.00 mA. Apply a 20.00 mA signal and press **Enter**. The display flashes for a moment while the meter is accepting the signal.

Error Message (Err)

An error message indicates that the calibration process was not successful. After the error message is displayed, the meter will revert to input 2 calibration settings. The error message might be caused by inadvertently leaving the signal at the previous level or not maintaining a 0.40 mA minimum span. Press the Menu button to cancel the current calibration process if necessary.

Operation

Front Panel Buttons Operation

Button Symbol	Description
MENU	Press to enter or exit Programming Mode or exit Max/Min readings
▶	Press to reset Max/Min readings
▲	Press to display Max/Min readings alternately
ENTER	Press to display Max or Min reading indefinitely while displaying Max or Min

Maximum & Minimum Readings (HI & LO)

The maximum and minimum (peak & valley) readings reached by the process are stored in the meter since the last reset or power-up. The meter flashes **HI** or **LO** to differentiate between run mode and max/min display.

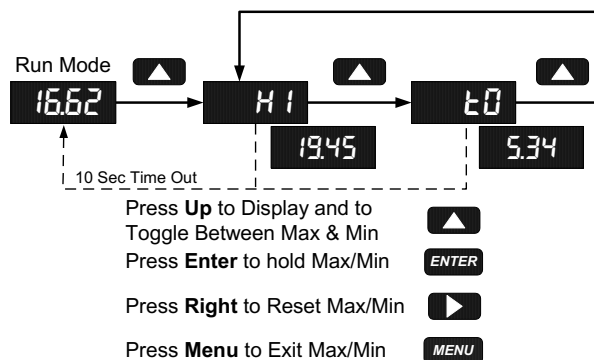

1. Press **Up** arrow button to display maximum reading since the last reset/power-up.
2. Press **Up** arrow again to display the minimum reading since the last reset/power-up.
3. Press **Enter** to continue to display the Max or Min display reading by disabling the Max/Min timeout. The meter will continue to track new Max/Min readings. Press **MENU** to exit the Max/Min reading.
4. If **Enter** is not pressed, the Max/Min display reading will continue to flash and time out after ten seconds. The meter will return to display the actual reading.
5. Press **Right** arrow button while in Max/Min Mode to reset both Max and Min. Max/Min display readings are reset to the current reading.

Reset Meter to Factory Defaults

When the parameters have been changed in a way that is difficult to determine what's happening, it might be better to start the setup process from the factory defaults.

Instructions to load factory defaults:

1. Enter the *Advanced* features menu. See Advanced Features Menu, page 9.
2. Press **Up** arrow button to display **Info** menu.
3. Press **RIGHT** arrow button when **Info** is shown.
4. Press **ENTER** button when **rst** is shown. Press **Enter** again when display flashes **rst**.
Note: If **Enter** is not pressed a second time within three seconds, **rst** will stop flashing and the last **ENTER** press cancelled.
5. The meter goes through an initialization sequence (same as on power-up), and loads the factory default settings.

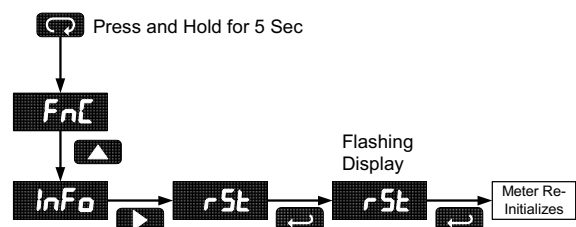

Factory Defaults & User Settings

The following table shows the factory setting for most of the programmable parameters on the meter. Next to the factory setting, the user may record the new setting for the particular application.

Model: _____

S/N: _____

Date: _____

Parameter	Display	Default Setting	User Setting
Decimal point	ddd	2 places	
Scale	5CL		
Number of Points	nPt	2	
Input 1	in 1	4.00 mA	
Display 1	d 1	4.00	
Input 2	in 2	20.00 mA	
Display 2	d 2	20.00	
Advanced Features			
Input Conditioning Function	Fnc	Linear	
Filter	F IL	Off	

Mounting Dimensions

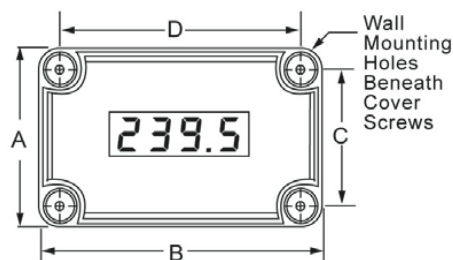

Figure 4. Case Dimensions – Front View

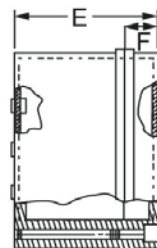

Figure 5. Case Dimensions – Side View

A: 3.15 in (80 mm)	B: 4.33 in (110 mm)	C: 2.44 in (62 mm)
D: 3.62 in (92 mm)	E: 2.76 in (70 mm)	F: 0.79 in (20 mm)

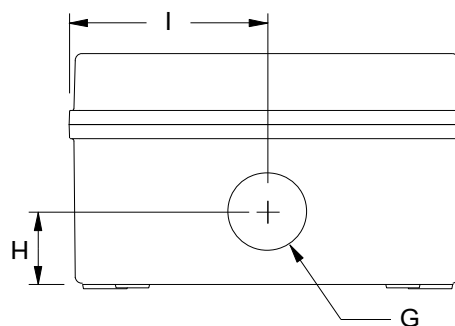

Figure 6. Case Dimensions – Bottom View

G: 0.87 in (22 mm)	H: 0.80 in (20 mm)	I: 2.17 in (55 mm)
-----------------------	-----------------------	-----------------------

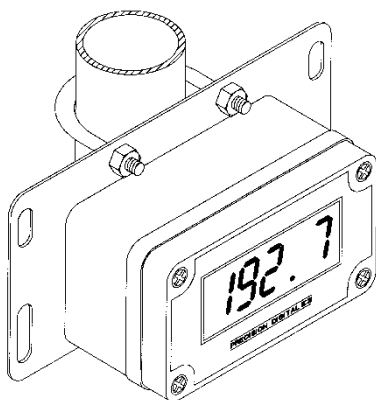

Figure 7. PDA6845 Pipe Mounting Kit

The PDA6845 pipe mounting kit may be used to mount a PD662 to a 2" pipe. The kit includes an 8.20 in (208 mm) x 4.10 in (104 mm) mounting panel with a 2" U-bolt and all necessary mounting hardware.

Troubleshooting

Due to the many features and functions of the meter, it's possible that the setup of the meter does not agree with what an operator expects to see. If the meter is not working as expected, refer to the recommendations described below.

Troubleshooting Tips

Symptom	Check/Action
No display or faint display	<ol style="list-style-type: none"> 1. Check connections. 2. Perform hard reset by temporarily shorting S+ and S- terminals for a few seconds.
Rate display unsteady	Increase filter setting in <i>Advanced</i> menu.
Meter displays error message during calibration (<i>Err</i>)	Check: <ol style="list-style-type: none"> 1. Signal connections 2. Minimum input span requirements
Meter flashes <ul style="list-style-type: none"> • 2999 • -1999 	Check: <ol style="list-style-type: none"> 1. Input signal within scaled range of 2999 and -1999.
Display stuck flashing a number and <i>H I</i> or <i>L O</i>	Press Menu to exit Max/Min display readings.
Display response is too slow	Check filter setting to see if it can be lowered to <i>L O</i> or <i>O F F</i> .
If the display locks up or the meter does not respond at all	Perform hard reset by temporarily shorting S+ and S- terminals for a few seconds and then removing short.
Backlight does not appear.	Check: <ol style="list-style-type: none"> 1. Meter has a backlight installed. 2. Signal connections are as shown in Figure 3 on page 6.
Other symptoms not described above	Call Technical Support for assistance.

Quick User Interface Reference Guide

Pushbutton	Function
Menu	Go to Programming Mode, leave Programming Mode, and Max/Min Mode. Hold for 5 seconds to access <i>Advanced Features</i> .
Right Arrow	Move to next digit or decimal point position. Reset Min/Max.
Up Arrow	Move to next selection or increment digit. Go to Max/Min Mode.
Enter	Accept selection/value and move to next selection.

Max/Min Mode

While in Run Mode, pressing **Up Arrow** will initiate Max/Min Mode. **Up Arrow** toggles between Max & Min displays, and **Right Arrow** resets the Max/Min to the current value. Press **Menu** or wait 10 seconds to return to Run Mode. Pressing **Enter** will disable the 10 second timeout and continuously flash Max or Min.

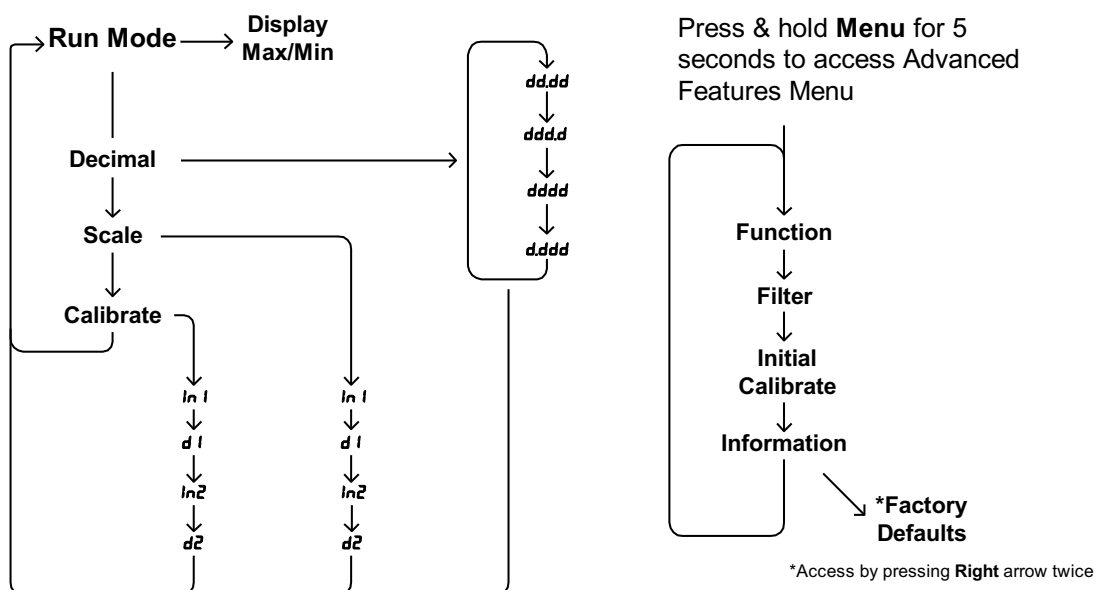

Operational Modes

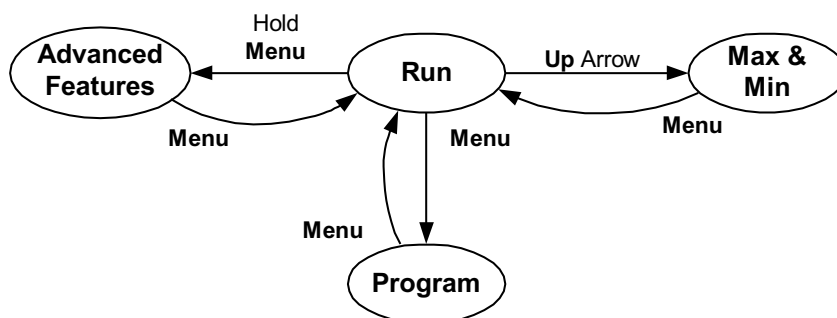

This page intentionally left blank



EU Declaration of Conformity

Issued in accordance with ISO/IEC 17050-1:2004.

We,

**Precision Digital Corporation
233 South Street
Hopkinton, MA 01748 USA**

as the manufacturer, declare under our sole responsibility that the product(s),

Model PD662 Survivor Series Loop Powered Meter

to which this declaration relates, is in conformity with the European Union Directives shown below:

**2014/35/EU Low Voltage Directive
2014/30/EU EMC Directive
2011/65/EU RoHS Directive**

This conformity is based on compliance with the application of harmonized or applicable technical standards and, when applicable or required, a European Union notified body certification.

Standards:

EN 61010-1:2001
EN 61326:2006

The standards EN 61010-1:2001, and EN 61326:2006 are no longer harmonized. The requirements of these standards have been checked against the harmonized standards EN 61010-1:2010, and EN 61326:2013 and there were no major technical changes affecting the latest technical knowledge for the products listed above.

Product Markings: (€

Signed for and on behalf of Precision Digital Corporation:

A handwritten signature in black ink, appearing to read "Jeffrey Peters", written over a horizontal line.

Name: Jeffrey Peters
Company: Precision Digital Corporation
Title: President
Date: 04/20/2016

Document No: DoC PD662 {042016}

PRECISION DIGITAL CORPORATION



LIM662_I
SFT054 Ver 1.800 & up
12/18