

DPC

PORT CONNECTOR

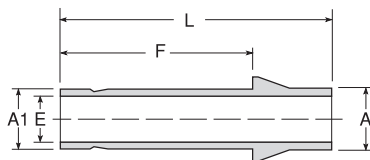

Note: SPECIAL INSTALLATION INSTRUCTIONS FOR MACHINED FERRULE END OF DPC.

From the finger-tight position, tighten nut 1/4 turn only. Subsequent connections are made by tightening slightly with a wrench after snugging nut by hand.

PART No.	A Tube OD	E Min Orifice	A1 Tube OD	F	L OAL
DPC-2-1-*	1/8"	0.03	1/16"	0.39	0.83
DPC-2-*	1/8"	0.09	1/8"	0.62	0.97
DPC-4-1-*	1/4"	0.03	1/16"	0.42	0.88
DPC-4-2-*	1/4"	0.09	1/8"	0.62	1.13
DPC-4-*	1/4"	0.19	1/4"	0.74	1.09
DPC-6-4-*	3/8"	0.19	1/4"	0.74	1.24
DPC-8-6-*	1/2"	0.28	3/8"	0.80	1.58
DPC-8-*	1/2"	0.39	1/2"	1.02	1.67
DPC-12-*	3/4"	0.59	3/4"	1.09	1.80
DPC-16-*	1"	0.80	1"	1.42	2.28

* Add Suffix "SS" for 316 Stainless Steel or "B" for Brass.

DRE

REDUCER

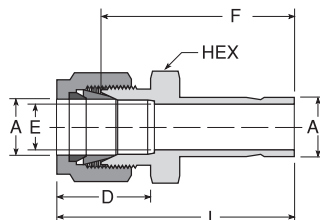
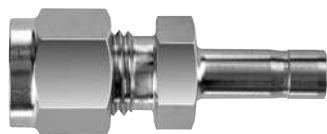

PART No.	A Tube OD	Hex Tube Nut	D	A1 Tube OD	E Min Orifice	F	L OAL	Hex Body
DRE-1-2-*	1/16"	5/16"	0.44	1/8"	0.05	1.00	1.15	5/16"
DRE-2-2-*	1/8"	7/16"	0.60	1/8"	0.08	1.06	1.32	7/16"
DRE-2-3-*	1/8"	7/16"	0.60	3/16"	0.09	1.09	1.36	7/16"
DRE-2-4-*	1/8"	7/16"	0.60	1/4"	0.09	1.16	1.42	7/16"
DRE-2-6-*	1/8"	7/16"	0.60	3/8"	0.09	1.22	1.48	7/16"
DRE-2-8-*	1/8"	7/16"	0.60	1/2"	0.09	1.48	1.74	9/16"
DRE-3-4-*	3/16"	1/2"	0.63	1/4"	0.08	1.20	1.46	7/16"
DRE-3-8-*	3/16"	1/2"	0.63	1/2"	0.12	1.50	1.84	9/16"
DRE-4-2-*	1/4"	9/16"	0.70	1/8"	0.08	1.16	1.45	1/2"
DRE-4-3-*	1/4"	9/16"	0.70	3/16"	0.12	1.19	1.48	1/2"
DRE-4-4-*	1/4"	9/16"	0.70	1/4"	0.19	1.25	1.54	1/2"
DRE-4-5-*	1/4"	9/16"	0.70	5/16"	0.19	1.28	1.57	1/2"
DRE-4-6-*	1/4"	9/16"	0.70	3/8"	0.19	1.31	1.60	1/2"
DRE-4-8-*	1/4"	9/16"	0.70	1/2"	0.19	1.54	1.82	9/16"
DRE-4-10-*	1/4"	9/16"	0.70	5/8"	0.19	1.53	1.89	11/16"
DRE-4-12-*	1/4"	9/16"	0.70	3/4"	0.19	1.69	1.89	7/8"
DRE-5-6-*	5/16"	5/8"	0.73	3/8"	0.25	1.36	1.65	9/16"
DRE-5-8-*	5/16"	5/8"	0.73	1/2"	0.25	1.58	1.87	9/16"

* Add Suffix "SS" for 316 Stainless Steel or "B" for Brass.

(CONTINUED ON NEXT PAGE)

Dimensions are provided in inches and are for reference only, subject to change. Dimensions shown are with the nut in the