

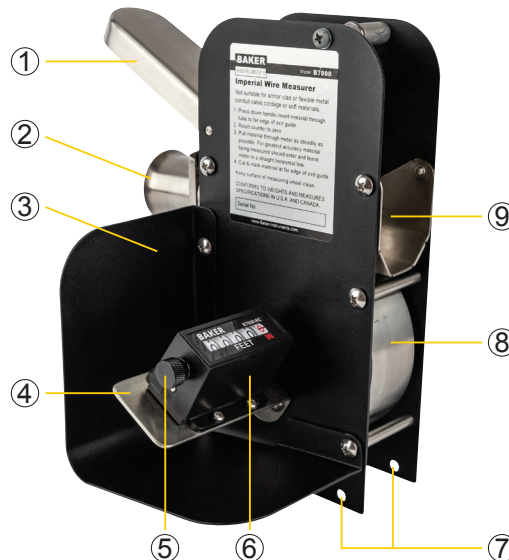

### Instrument Description



1. Handle
2. Interchangeable Guide Tube
3. Counter Shield
4. Counter Bracket
5. Counter Reset Dial
6. Counter
7. Mounting Screw Holes
8. Measuring Wheel
9. Exit Guide

### Introduction

Thank you for purchasing your BAKER B7000 Wire Measurer. Please read the following instructions carefully before using your instrument. By following the steps outlined in this manual your product will provide years of reliable service.

### Safety

Never attempt to repair or modify your instrument. Dismantling your product may cause damage that will not be covered under the manufacturer's warranty. Servicing should only be provided by an authorized service center.

### Features

- Measures in feet and inches
- 1/4" and 1" guide tubes provide accurate measurement of various materials
- Stainless steel structure ensures long-lasting performance
- Low-friction guiding components guarantee straight-line contact for accurate measurements
- High-speed mechanical counter deliver fast, reliable readings
- Five-figure register with knob reset

### Included

- Wire Measurer
- Mounting Screws
- Mounting Nuts

### Specifications

|                           |   |
|---------------------------|---|
| Compatible Wire Diameter: | 1/64 to 7/8"                              |
| Unit of Measure:          | Imperial (feet and inches)                |
| Mechanical counter:       | Up to 9,999-11"                           |
| Materials:                | Stainless steel                           |
| Dimensions:               | 8.25 x 7.25 x 4.9"<br>(210 x 184 x 125mm) |
| Weight:                   | 4.5lbs (2.04kg)                           |

### Operating Instructions

1. Unpack instrument carefully.
2. Mount securely into place using the 2 screws and 2 nuts.
3. After mounting instrument, press Handle and rotate Measuring Wheel in both directions.

**Warning:** The Wheel and Counter should spin freely. If not, examine pin-and-slot coupling between wheel shaft and Counter. This should not bind. If necessary, the position on the Counter Bracket can be adjusted laterally by loosening the four screws. If Wheel and Counter still fail to rotate freely, contact your authorized Baker Instruments distributor for assistance.

4. Press down Handle, insert material through tube to far edge of exit guide.

#### Wire Measurer Capacity

Flexible wires: 1/64 to 7/8" (0.4 to 22mm)

Metal cables: 1/64 to 1/2" (0.4 to 13mm)

5. Reset counter to zero.
6. Pull material through meter as steadily as possible. For greatest accuracy, material being measured should enter and leave meter in a straight, horizontal line.
7. Cut and mark material at far edge of exit guide.

### Accessory and Replacement Part

**B7000-RC** Replacement Counter, feet and inches