



# Model 5035, 5036

## Analog Panel Meter



**3-1/2" 5035** DC Moving Coil

**3-1/2" 5036** AC Repulsion

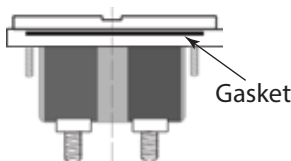
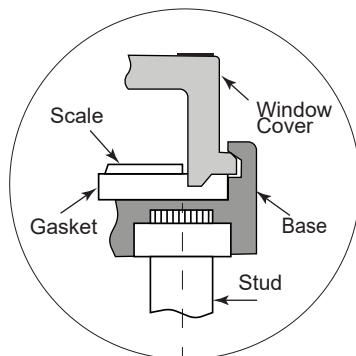

### Features

- **Gasket Sealing Design**

Dust resistant construction is a standard feature.

This unique sealing design provides exceptional gasket sealing while allowing for quick modification and scale changes while maintaining the integrity of the instrument.

\*External panel gasket available.

- **Dustproof Lexan® Construction**

5000 series panel meters feature gasketed construction to seal out dust and other air-suspended damaging particles. Made with UL 94V material.

Ideal where impact and strength is required in harsh environments.

- **DC Ranges:** Microammeter, Milliammeter, Ammeter, Millivoltmeter, Voltmeter.

- **AC Ranges:** Milliammeter, Ammeter, Voltmeter, Frequency Meter, Motor Load Meter.

- Equivalent to Yokogawa Big Look® (use 3 stud mounting option)

### Specifications

Overload:	Voltmeters (AC and DC): 50% momentary 20% sustained. Ammeters (AC and DC) momentary: 10 times the rated current for 10 consecutive intervals of .5 seconds with a 1 minute interval between successive applications; 20% for six hours.
Accuracy:	±2% full scale value.
Resistance:	±15%.
Dials:	100 or 90 degree arc, black lettering on white background.
Pointer:	Airplane.
Movement:	Pivot and Jewel, AC Iron Vane or Taut Band.
Mounting:	Specify (S) Surface mount.
Case:	Clear polystyrene cases standard. Acrylic or high impact polycarbonate case are available in some models.
Operating Temp.:	32°F to 104°F (0°C to 40°C).
Storage Temp.:	-4°F to 131°F (-20°C to 55°C).
Meter Approvals:	ANSI C39.1, RoHS, REACH, UL Recognized (upon request).
Origin:	Made in USA.



# Model 5035, 5036

## Analog Panel Meter

### Dimensions

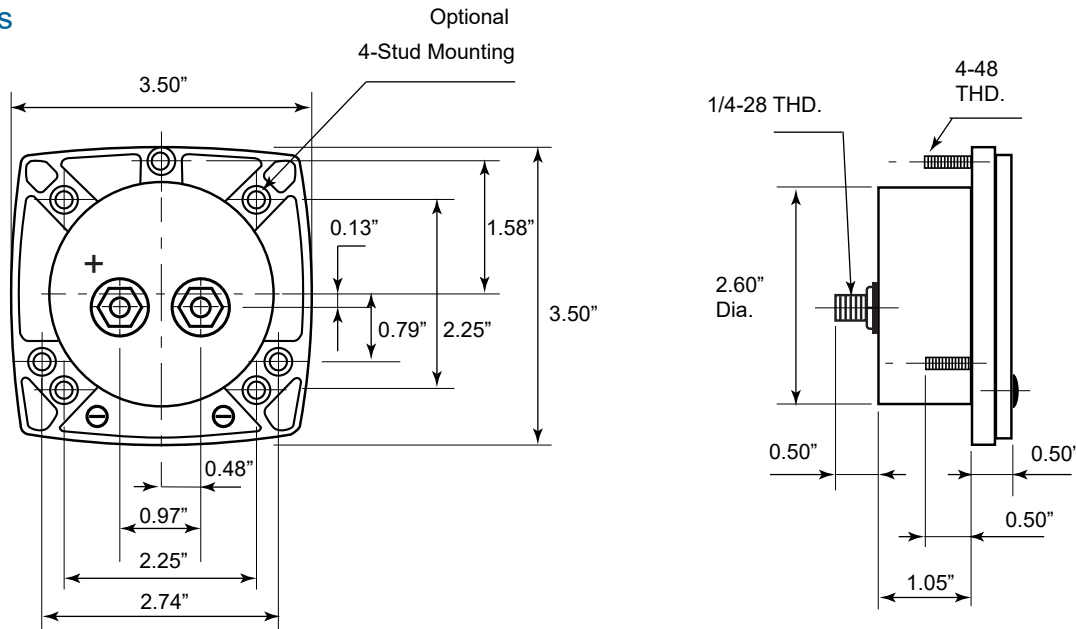

### Stud mounting options

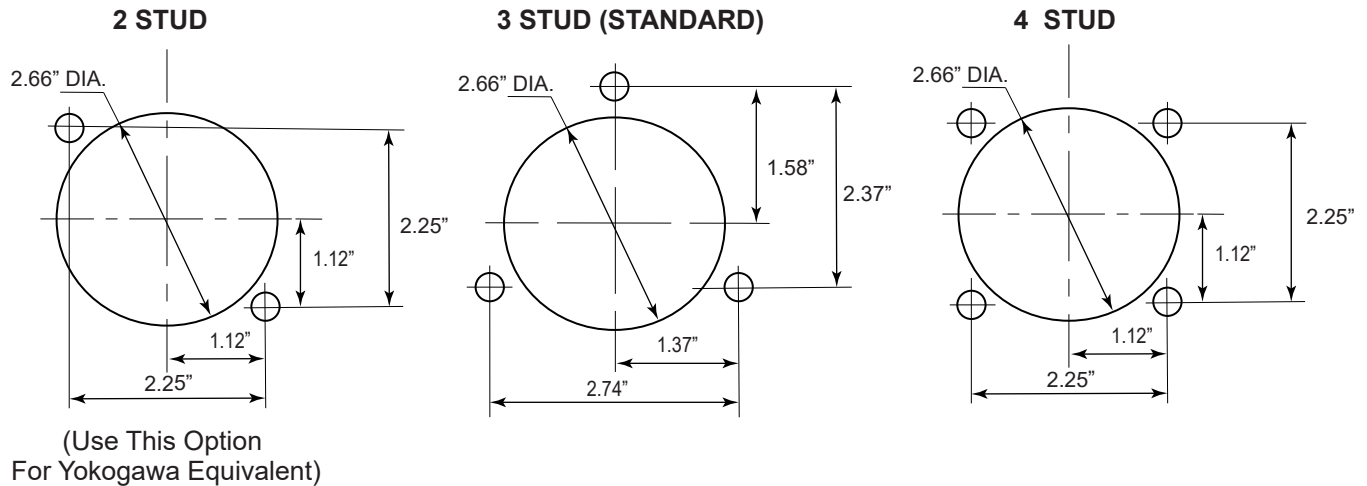

The mounting studs on the 5000 Series can be ordered to fit your existing panel openings at no extra cost. The 5000 Series cases are interchangeable with a wide variety of competitive instruments. Dimensions are shown above. This built-in interchangeability eliminates the need for drawing changes, setups, and redrilling of panels... and it solves your instrument replacement problems.

If you require a 2-stud option different than the option shown above please consult the factory.