

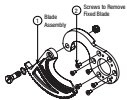

**FASTER, TOUGHER, AND MORE DURABLE.
STAY A CUT ABOVE.**



REPLACEMENT BLADES, GEAR BOX & PARTS



**POWERBLADE 750
CABLE CUTTER 35-076**

ITEM NO.	PART NO.	DESCRIPTION	QTY.
1	K-09008	Blade Pair Assembly	1
12	113.190	10-32 x .375 PMMS Hex Screw	6

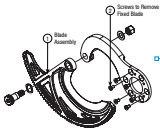

**BIG KAHUNA
CABLE CUTTER 35-076**

ITEM NO.	PART NO.	DESCRIPTION	QTY.
1	KH-02708	Blade Pair Assembly	1
2	113.190	10-32 x .375 PMMS Hex Screw	6

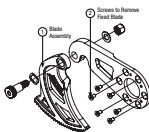

**MERLIN
ACSR CABLE CUTTER 35-077**

ITEM NO.	PART NO.	DESCRIPTION	QTY.
1	MB-02708	Blade Pair Assembly	1
2	113.190	10-32 x .375 PMMS Hex Screw	6

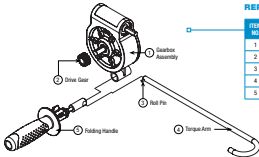

**GEAR BOX ASSEMBLY AND
REPLACEMENT PARTS**

ITEM NO.	PART NO.	DESCRIPTION	QTY.
1	H-2400	Gearbox Assembly	1
2	KH-0450	Drive Gear	1
3	201.190	125 Dia x .625 Roll Pin	1
4	K-0822	Tension Arm	1
5	H-2607	Folding Handle	1

Printed On: P-0022
©2013 IDEAL INDUSTRIES, INC.

1013 Printed in USA



POWERFUL FAST DURABLE EASY-TO-USE



BIG ENOUGH FOR ANY JOB.

The new series of IDEAL PowerBlade™ Cable Cutters are designed to cut cables quickly and efficiently. With adjustable torque arms, heavy-duty gears, and proprietary hardened steel blades, they deliver unsurpassed performance, ease-of-use, and durability. Compatible with any 12-volt or higher drill so that cutting is as effortless as pulling the drill's trigger. The PowerBlade™ Cable Cutter's unique compact design is the perfect tool for fitting into tight spaces. They also feature ergonomically designed, non-slip grips – helping you cut cable easily and safely.

Try one and you'll never use anything else again!

IDEAL POWERBLADE™ CABLE CUTTERS

PowerBlade™ Cable Cutters make easy work of cutting small to large diameter cables, resulting in clean, installation-ready cuts.



IDEAL Cable Geometry

MANUAL, RATCHETING OR BATTERY-POWERED CABLE CUTTERS

VS



"Football" Shattering

THE COMPETITIVE EDGE.

- Superior hardened steel blades ensure precision with every cut
- Contoured blade design minimizes cable distortion
- Adjustable torque arm firmly holds drill in place
- Exceptionally rugged gears and metal housing
- Maintenance-free gearbox
- Protective shield
- Ergonomically designed, textured grip
- Folding handle – fits in Tight Spaces!
- Cuts cable without looping or ratcheting

Designed to last for thousands of cuts!

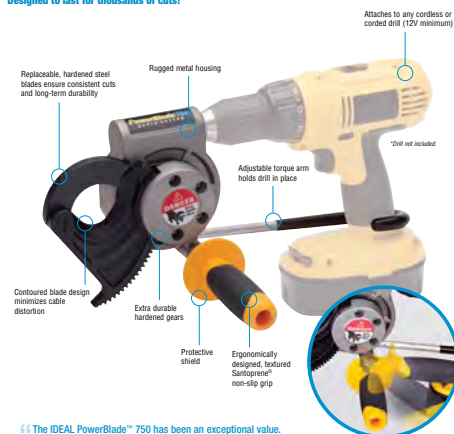

“The IDEAL PowerBlade™ 750 has been an exceptional value. The speed and ease at which it cuts conductors is amazing! The time savings on one job alone more than pays for this tool.”

KELVIN WORKMAN, KEARNEY ELECTRIC, INC., PHOENIX, AZ

PowerBlade™750 CABLE CUTTER



35-078

- Extremely versatile and designed for multiple applications
- Jaw opening of 1 1/2"
- Cuts copper cable up to 750MCM and aluminum cable up to 1000MCM
- Specially hardened, rounded blades minimize cable distortion for professional quality every time

CUTS COPPER UP TO 750MCM
CUTS ALUMINUM UP TO 1000MCM

1 1/2" MAX JAW OPENING

BIG KAHUNA™ CABLE CUTTER



35-078

- Rock Solid power blade designed for heavy duty applications involving large diameter cable
- Up to 3 1/2" Jaw Opening. Cuts through most large-diameter cable
- Leaves a clean, installation-ready cut each time, every time
- Superior blade durability. Cuts copper and aluminum up to 1250 MCM!

CUTS COPPER AND ALUMINUM UP TO 1250MCM

3 1/2" MAX JAW OPENING

Merlin™ ACSR CUTTER



35-077

- Especially designed for applications involving stainless steel reinforced aluminum cable
- Jaw opening of 3/4" for precision and accuracy
- Cuts up to 3/4" Merlin ACSR

CUTS ACSR CABLE UP TO 3/4"

3/4" MAX JAW OPENING