

PROBES FOR Si-RM350 / Si-RM450 MANIFOLDS

Quick Start Guide

- EN
- FR
- ES
- IT
- DE
- PT
- NL
- ZH



Register your product online to confirm your warranty and benefit from the full Sauermann range.

sauermanngroup.com

English Quick Start Guide

These operating instructions describe how to use and connect the Si-RT2, Si-RT5, Si-RT7, Si-TH4, Si-RP4 and Si-RV4 probes properly. Please refer to the operating instructions available at sauermanngroup.com for safe use of the manifolds and detailed information. Do not give these devices to a child.

1. Insert batteries on Si-RT7, Si-TH4, Si-RP4 and Si-RV4 wireless probes

Type of batteries: 3x LR03 AAA 1.5 V alkaline batteries

Example with a Si-RP4 or Si-RV4 probe:



For Si-TH4 and Si-RT7 probes, there is no batteries holder. Simply put batteries respecting the polarity.

2. Wireless probe On/Off button

ON: Briefly press the button. LED turns on.

OFF: Press and hold the button for 3 seconds. The LED flashes 3 times and goes off.

3. Connect a wireless probe to a manifold

Before using a probe for the 1st time, this probe must be paired with the manifold (except for the Si-RP4 probes which can only communicate with the Sauermann Pilot app).

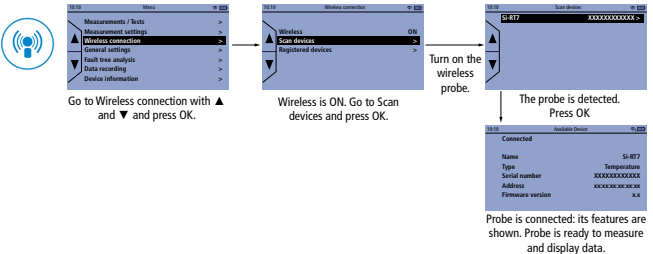

4. Use a wireless probe with a smartphone

It's possible to connect a probe to a smartphone using the Sauermann Pilot app.

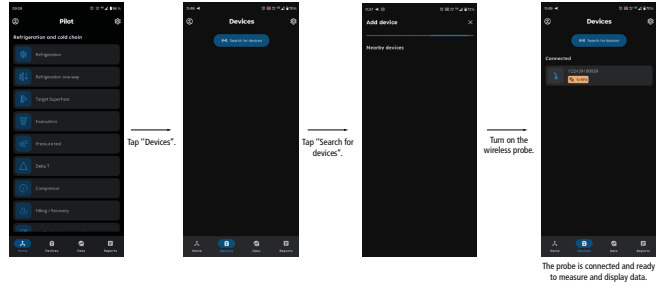

The probe is connected and ready to measure and display data.

5. Wired probe connections

