

# PROBES FOR Si-RM350 / Si-RM450 MANIFOLDS

## Quick Start Guide

- EN
- FR
- ES
- IT
- DE
- PT
- NL
- ZH



Register your product online to confirm your warranty and benefit from the full Sauerermann range.

# English Quick Start Guide

These operating instructions describe how to use and connect the Si-RT2, Si-RT5, Si-RT7, Si-TH4, Si-RP4 and Si-RV4 probes properly. Please refer to the operating instructions available at sauermanngroup.com for safe use of the manifolds and detailed information. Do not give these devices to a child.

## 1. Insert batteries on Si-RT7, Si-TH4, Si-RP4 and Si-RV4 wireless probes

Type of batteries: 3x LR03 AAA 1.5 V alkaline batteries

Example with a Si-RP4 or Si-RV4 probe:



For Si-TH4 and Si-RT7 probes, there is no batteries holder. Simply put batteries respecting the polarity.

## 2. Wireless probe On/Off button

ON: Briefly press the button. LED turns on.

OFF: Press and hold the button for 3 seconds. The LED flashes 3 times and goes off.

## 3. Connect a wireless probe to a manifold

Before using a probe for the 1<sup>st</sup> time, this probe must be paired with the manifold (except for the Si-RP4 probes which can only communicate with the Sauermann Pilot app).

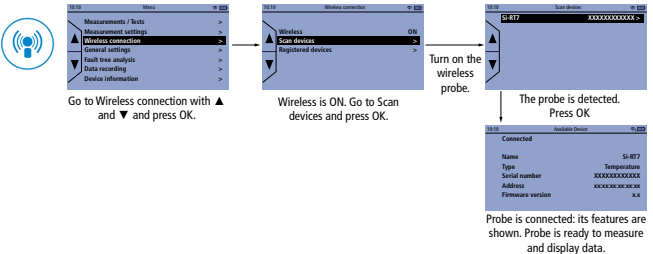

Probe is connected: its features are shown. Probe is ready to measure and display data.

## 4. Use a wireless probe with a smartphone

It's possible to connect a probe to a smartphone using the Sauermann Pilot app.

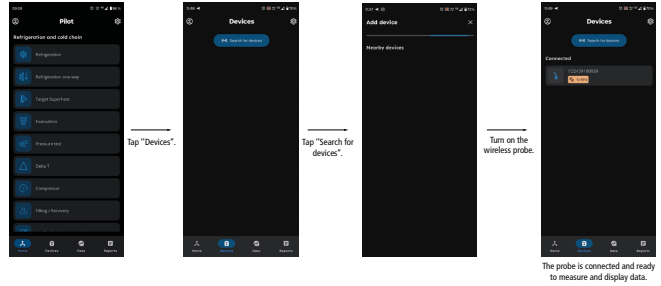

The probe is connected and ready to measure and display data.

## 5. Wired probe connections

